

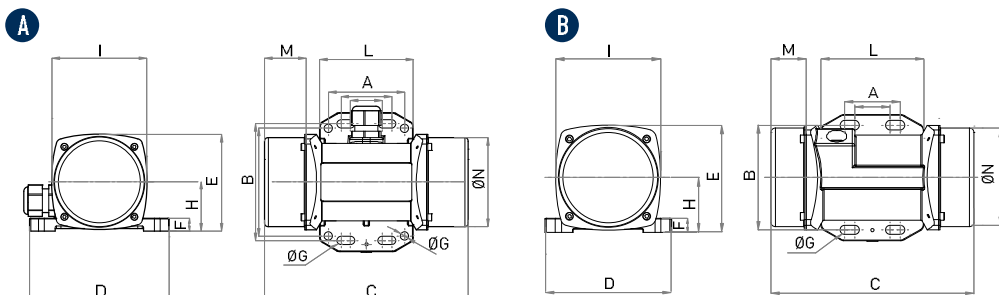

# MVE-MICRO - 2 poles electric vibrators



MODEL		DRAW.	C		M		A		B		ØG		HOLES n°	D		E		F		H		I		L		N		SCREW	
50 Hz	60 Hz - USA		mm	in	mm	in	mm	in	mm	in	mm	in		mm	in	mm	in	mm	in	mm	in	mm	in	mm	in	mm	in	mm	in
MVE 21/3E-MICRO	MVE 21/36E-MICRO	A	145	5.7	25	1.0	25-40 60	1-1.6 2.4	92 85	3.6 3.3	6.5 6.5	0.3 0.3	4	110	4.3	76.5	3.0	10	0.4	39	1.5	75	3.0	74	2.9	70.5	2.8	M5	3/16"
MVE 41/3E-MICRO	MVE41/36E-MICRO	B	145	5.7	25	1.0	25-40 60	1-1.6 2.4	75 85	3.0 3.3	6.5 6.5	0.3 0.3	4	90	3.5	76.5	3.0	10	0.4	39	1.5	75	3.0	74	2.9	70.5	2.8	M5	3/16"
MVE 3/3E-MICRO-M	MVE 3/36E-MICRO-M	A	145	5.7	25	1.0	25-40 60	1-1.6 2.4	92 85	3.6 3.3	6.5 6.5	0.3 0.3	4	110	4.3	76.5	3.0	10	0.4	39	1.5	75	3.0	74	2.9	70.5	2.8	M5	3/16"
MVE 6/3E-MICRO-M	MVE 6/36E-MICRO-M	B	145	5.7	25	1.0	25-40 60	1-1.6 2.4	75 85	3.0 3.3	6.5 6.5	0.3 0.3	4	90	3.5	76.5	3.0	10	0.4	39	1.5	75	3.0	74	2.9	70.5	2.8	M5	3/16"
MVE 21/3E-MICRO-M	MVE 21/36E-MICRO-M	A	145	5.7	25	1.0	25-40 60	1-1.6 2.4	92 85	3.6 3.3	6.5 6.5	0.3 0.3	4	110	4.3	76.5	3.0	10	0.4	39	1.5	75	3.0	74	2.9	70.5	2.8	M5	3/16"
MVE 41/3E-MICRO-M	MVE 41/36E-MICRO-M	A	161	6.3	33	1.3	25-40 60	1-1.6 2.4	92 85	3.6 3.3	6.5 6.5	0.3 0.3	4	110	4.3	76.5	3.0	10	0.4	39	1.5	75	3.0	74	2.9	70.5	2.8	M5	3/16"

## MVE-MICRO THREE PHASE - 3000 RPM 400V 50HZ / 3600 RPM 460V 60HZ

MODEL		WORKING MOMENT		CENTRIFUGAL FORCE				WEIGHT		ELECTRICAL FEATURES				COSΦ							
		POWER		CURRENT																	
		kgcm	inlb	kg	lb	kW	Hp	A max	230V	400V	460V	230V	400V	460V							
50 Hz	60 Hz - USA	50Hz	60Hz	50Hz	60Hz	50Hz	60Hz	kg	lb	50Hz	60Hz	50Hz	60Hz	50Hz	60Hz	50Hz	60Hz				
MVE 21/3E-MICRO	MVE 21/36E-MICRO	0.40	0.40	0.35	0.35	20	29	44	64	2.0	4.4	0.04	0.04	0.05	0.05	0.21	0.12	0.12	0.45	0.45	0.42
MVE 41/3E-MICRO	MVE41/36E-MICRO	0.90	0.90	0.78	0.78	45	65	99	143	2.4	5.3	0.06	0.06	0.08	0.08	0.30	0.18	0.18	0.44	0.44	0.40

## MVE-MICRO SINGLE PHASE - 3000 RPM 230V 50HZ / 3600 RPM 115V 60HZ

MODEL		WORKING MOMENT		CENTRIFUGAL FORCE				WEIGHT		ELECTRICAL FEATURES				COSΦ					
		POWER		CURRENT															
		kgcm	inlb	kg	lb	Kw	Hp	A max	230V	115V	230V	115V							
50 Hz	60 Hz - USA	50Hz	60Hz	50Hz	60Hz	50Hz	60Hz	kg	lb	50Hz	60Hz	50Hz	60Hz	50Hz	60Hz	50Hz	60Hz		
MVE 3/3E-MICRO-M	MVE 3/36E-MICRO-M	0.08	0.08	0.07	0.07	4	6	9	13	1.6	3.5	0.03	0.04	0.04	0.05	0.30	0.80	0.43	0.43
MVE 6/3E-MICRO-M	MVE 6/36E-MICRO-M	0.12	0.12	0.10	0.10	6	9	13	20	1.6	3.5	0.03	0.04	0.04	0.05	0.30	0.80	0.43	0.43
MVE 21/3E-MICRO-M	MVE 21/36E-MICRO-M	0.40	0.40	0.35	0.35	20	29	44	64	2.0	4.4	0.04	0.07	0.05	0.09	0.20	0.80	0.80	0.80
MVE 41/3E-MICRO-M	MVE 41/36E-MICRO-M	0.90	0.90	0.78	0.78	45	65	99	143	2.4	5.3	0.05	0.07	0.07	0.09	0.25	0.80	0.80	0.80

## MVE-MICRO - 2 POLES ELECTRIC VIBRATORS - THREE PHASE / SINGLE PHASE

APPLICATION	Small hopper - micro screen - chute - vibrating feeder table and channels
POWDER	Fine - dry
PROBLEM SOLVING	Bridge and rat-holing

### FEATURES

DUTY CYCLE	Continuous - S1
ENVIRONMENT TEMPERATURE	From -20 °C to 40 °C (from -4 °F to 104 °F)
MAX NOISE LEVEL	76 dB(A)
ATEX	II3D Ex tc IIIC Tx IP 66
MATERIAL	Body aluminium - stainless steel cover
CAPACITOR	MICRO 21 - 115v µF 4, 220v 50/60Hz µF1,5   MICRO 41 - 115v µF 4, 220v 50/60Hz µF3

### OPTIONS

ATEX	Ex II 2D Ex tb IIIC Tx Db IP 66 Ex tb IIIC Tx Db IP66
CUSTOMISED CABLE	Available

